



Rowan Court, Worcester Road, Droitwich, WR9 8AH

Offers Over £175,000

🛏 2 🚿 1 🚗 0



This beautifully presented ground floor retirement apartment for the over 55's offers an enviable position in the Rowan Court complex, being tucked away at the end of the building with French doors to the garden. The property benefits from a private position and excellent condition, as well as being offered with NO ONWARD CHAIN, low service charges and off road parking.



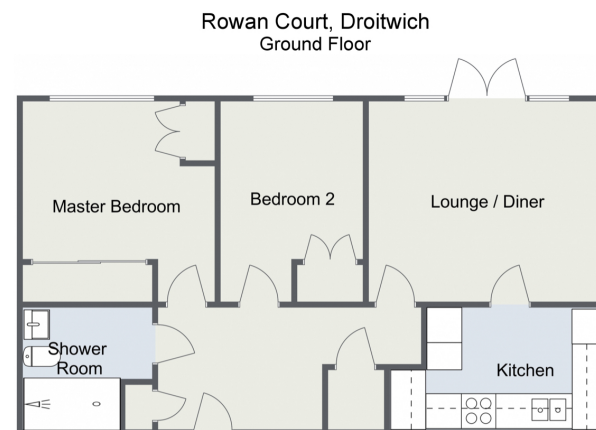

Total Area Approx
56.4 Sq M
607.08 Sq Ft

For illustrative purposes only. Decorative finishes, fixtures & fittings do not represent the current state of the property. Measurements are approximate & not to scale. Floor Plans made using RoomSketcher.



For more information on this house or to arrange a viewing please call the office on:

01905 958 290

Alternatively, you can scan the QR to view all of the details of this property online.



arden
ESTATE AGENTS